



● **FEATURES 特性**

Various high power inductors are superior to be high saturation for surface mounting.

具有高功率、高饱和电流、低阻抗、小型化之特性。

● **APPLICATIONS 用途**

Power supply for TVR,OA equipment Digital camera,LCD television set notebook PC, portable communication equipments,DC/DC converters,etc.

录影机，OA仪器，数码相机，液晶电视，笔记本电脑，小型通信设备，DC/DC转换器。

● **PART NUMBERING SYSTEM 品名系统**

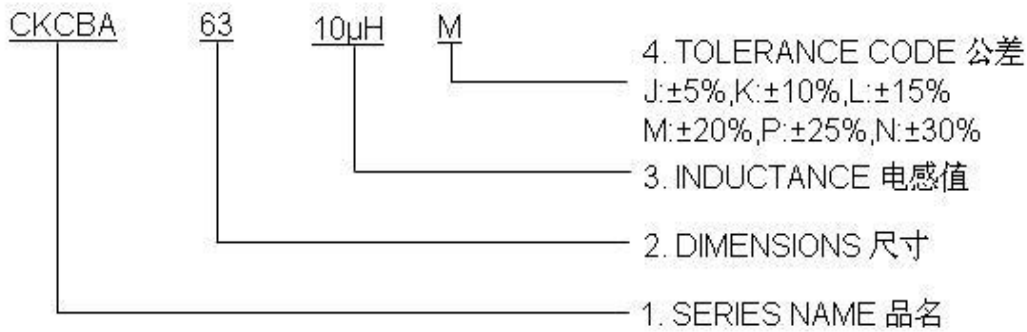

● **SHAPES AND DIMENSIONS 外形尺寸 (Unit:mm)**

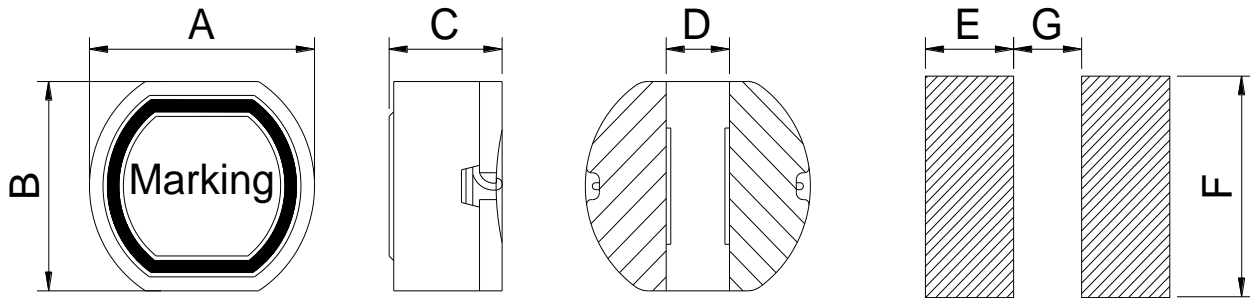

Recommended patterns

TYPE(型号)	A	B	C	D	E	F	G
CKCBA63	6.2±0.5	5.6±0.5	3.2±0.5	1.7	2.3	6.0	1.6
CKCBA74	7.8±0.5	7.0±0.5	4.5±0.5	2.0	3.0	7.5	2.0
CKCBA105	10.0±0.5	9.0±0.5	5.0±0.5	2.5	3.75	9.5	2.5



● SPECIFICATION TABLE:

PART NUMBER 品名	INDUCTANCE (μ H) 电感值	DCR (Max) (Ω) 直流电阻	IDC (Max) (A) 额定电流	TEST FREQ (kHz) 测试频率
CKCBA63-10uH/M	10 \pm 20%	0.16	1.20	100
CKCBA63-12uH/M	12 \pm 20%	0.16	1.10	100
CKCBA63-15uH/M	15 \pm 20%	0.18	1.00	100
CKCBA63-18uH/M	18 \pm 20%	0.28	0.90	100
CKCBA63-22uH/M	22 \pm 20%	0.30	0.80	100
CKCBA63-27uH/M	27 \pm 20%	0.36	0.64	100
CKCBA63-33uH/M	33 \pm 20%	0.41	0.60	100
CKCBA63-39uH/M	39 \pm 20%	0.47	0.53	100
CKCBA63-47uH/M	47 \pm 20%	0.55	0.50	100
CKCBA63-56uH/M	56 \pm 20%	0.72	0.46	100
CKCBA63-68uH/M	68 \pm 20%	0.82	0.42	100

● SPECIFICATION TABLE:

PART NUMBER 品名	INDUCTANCE (μ H) 电感值	DCR (Max) (Ω) 直流电阻	IDC (Max) (A) 额定电流	TEST FREQ (kHz) 测试频率
CKCBA74-10uH/M	10 \pm 20%	0.070	1.65	100
CKCBA74-12uH/M	12 \pm 20%	0.075	1.57	100
CKCBA74-15uH/M	15 \pm 20%	0.08	1.39	100
CKCBA74-18uH/M	18 \pm 20%	0.10	1.29	100
CKCBA74-22uH/M	22 \pm 20%	0.13	1.12	100
CKCBA74-27uH/M	27 \pm 20%	0.16	1.06	100
CKCBA74-33uH/M	33 \pm 20%	0.18	0.97	100
CKCBA74-39uH/M	39 \pm 20%	0.23	0.91	100
CKCBA74-47uH/M	47 \pm 20%	0.27	0.80	100
CKCBA74-56uH/M	56 \pm 20%	0.29	0.76	100
CKCBA74-68uH/M	68 \pm 20%	0.33	0.68	100
CKCBA74-82uH/M	82 \pm 20%	0.43	0.62	100
CKCBA74-100uH/M	100 \pm 20%	0.49	0.55	100
CKCBA74-120uH/M	120 \pm 20%	0.68	0.48	100
CKCBA74-150uH/M	150 \pm 20%	0.94	0.44	100
CKCBA74-180uH/M	180 \pm 20%	1.00	0.40	100
CKCBA74-220uH/M	220 \pm 20%	1.18	0.36	100
CKCBA74-270uH/M	270 \pm 20%	1.30	0.33	100



● SPECIFICATION TABLE:

PART NUMBER 品名	INDUCTANCE (μ H) 电感值	DCR (Max) (Ω) 直流电阻	IDC (Max) (A) 额定电流	TEST FREQ (kHz) 测试频率
CKBA105-10uH/M	10 \pm 20%	0.06	2.06	100
CKBA105-12uH/M	12 \pm 20%	0.07	1.94	100
CKBA105-15uH/M	15 \pm 20%	0.07	1.72	100
CKBA105-18uH/M	18 \pm 20%	0.08	1.58	100
CKBA105-22uH/M	22 \pm 20%	0.08	1.42	100
CKBA105-27uH/M	27 \pm 20%	0.10	1.32	100
CKBA105-33uH/M	33 \pm 20%	0.11	1.16	100
CKBA105-39uH/M	39 \pm 20%	0.12	1.10	100
CKBA105-47uH/M	47 \pm 20%	0.14	1.00	100
CKBA105-56uH/M	56 \pm 20%	0.19	0.93	100
CKBA105-68uH/M	68 \pm 20%	0.21	0.85	100
CKBA105-82uH/M	82 \pm 20%	0.28	0.79	100
CKBA105-100uH/M	100 \pm 20%	0.34	0.72	100
CKBA105-120uH/M	120 \pm 20%	0.37	0.63	100
CKBA105-150uH/M	150 \pm 20%	0.51	0.55	100
CKBA105-180uH/M	180 \pm 20%	0.57	0.50	100
CKBA105-220uH/M	220 \pm 20%	0.78	0.47	100
CKBA105-270uH/M	270 \pm 20%	0.87	0.41	100
CKBA105-330uH/M	330 \pm 20%	1.20	0.37	100
CKBA105-390uH/M	390 \pm 20%	1.34	0.35	100
CKBA105-470uH/M	470 \pm 20%	1.50	0.33	100

Remark: ● Inductance Tested at 100kHz,0.25Vrms (20°C)

- IDC: DC current at which the inductance drops approximate 20% from its value without current
- Operating Temperature : -25°C ~ +105°C
- Measure Equipment:
INDUCTANCE : Agilent HP-4284A , HP-4285A
IDC : Agilent HP-4284A+HP-42841A
DCR : CHEN HWA 502A



● PACKAGING SPECIFICATION :

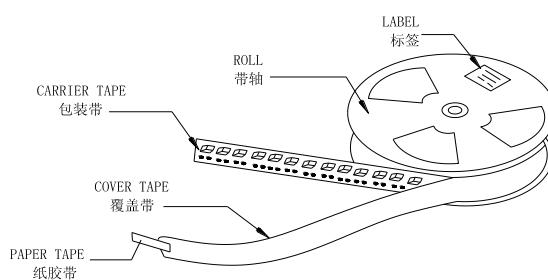
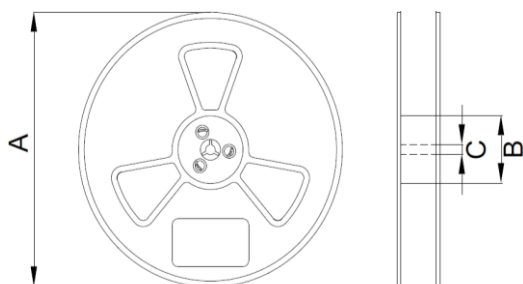
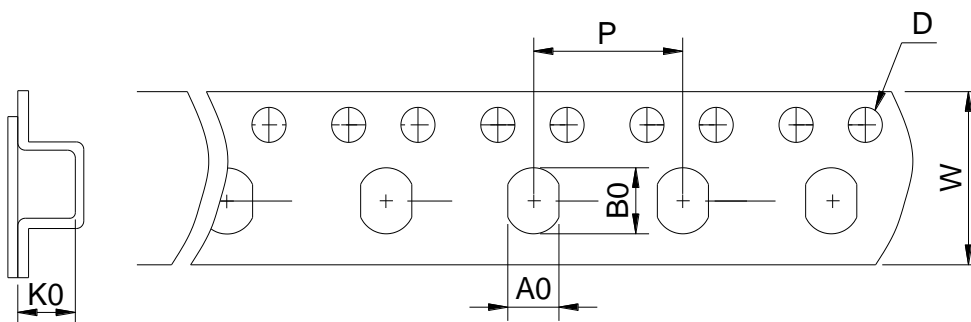

Type	Tape Dimension						Reel Dimension			Quantity (Pcs/Reel)
	W	A0	B0	K0	D	P	A	B	C	
CKCBA63	12.0	6.0	6.5	3.8	1.5	12.0	330	10	13	1500
CKCBA74	16.0	7.6	8.6	5.6	1.5	12.0	330	10	13	1000
CKCBA105	24.0	9.1	10.1	6.1	1.5	12.0	330	10	13	1000